

## Luxury 1 Bedroom & Den

Livable: 948 sq.ft. - 962 sq.ft.

Suite 729 - 743 sq.ft. + Solarium/deck 219 sq.ft.

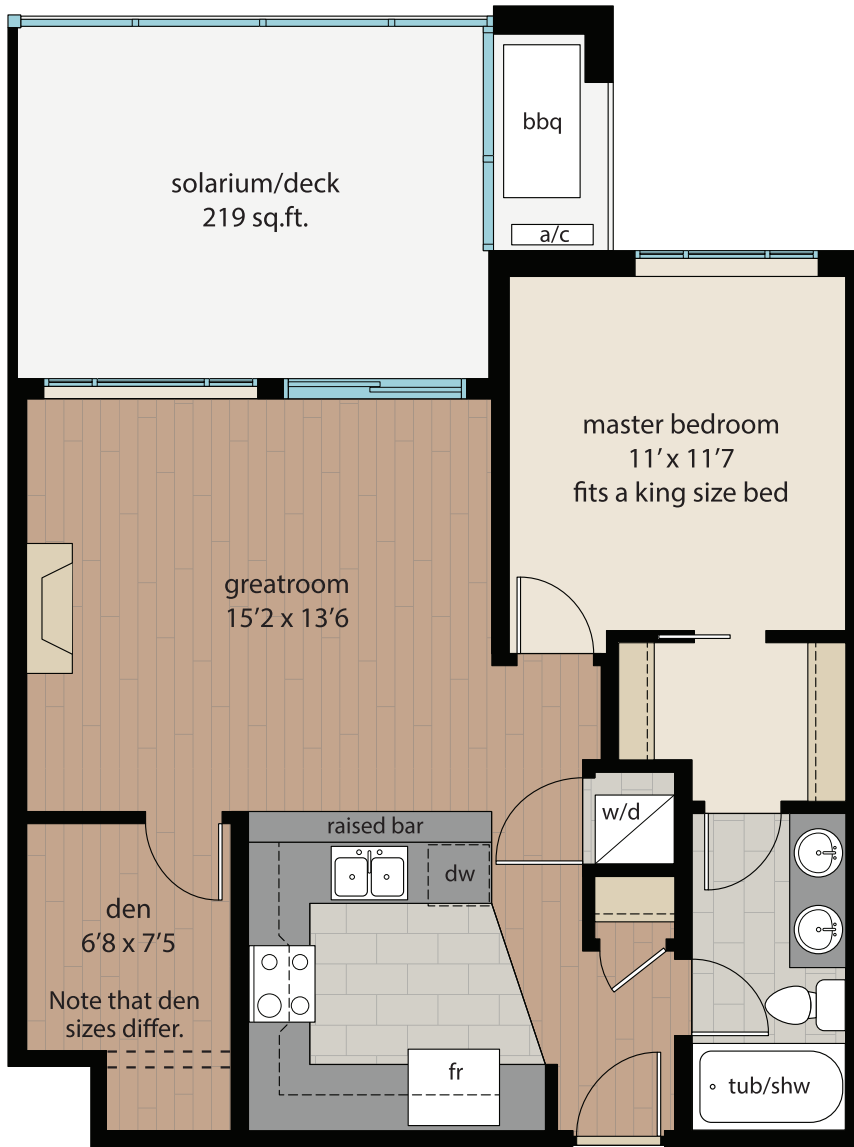

### Style B/B7

103	229,900
104	229,900
109	229,900
110	229,900
111	229,900
112	229,900
118	229,900
119	229,900
122	229,900
123	229,900
203	229,900
204	249,900
209	249,900
210	249,900
211	249,900
212	249,900
218	249,900
219	249,900
222	249,900
223	249,900
304	259,900
404	264,900
504	274,900
604	299,900

Est. monthly strata fees: \$134

FINANCIAL SUMMARY	
<b>Style B/B7 - example price: \$229,900</b>	
When contract is written	\$0
10 days later, to make the deal firm	\$5000
60 days later, to complete the 5.25% down payment	\$7070
After move-in, monthly payments on a 95% mortgage @ 2.64%	\$1061
<b>Payments are much lower with a higher down payment.</b>	



Simon Avenue